

Chapter 4. Installation

4. Installation

4.1 Unpacking

- 1) Unpack the machine on top of the pallette.
- 2) Cut the straps that are fastened around the box with a knife. (refer to Fig. 4.1.1)
(Be careful when cutting the straps.)
- 3) Use an appropriate tool to remove the nails from the pallette. (refer to Fig. 4.1.2)
- 4) Remove the lid, then box from the top. Do not discard the packaging materials until you have verified any shipping damage claim. Contact your distributor immediately if you see any shipping damage.
Store the box in a safe place to re-use or discard of appropriately.
- 5) Verify the contents carefully with the packing list to be sure all items listed are included. Notify your distributor of any shortages.
- 6) If only the pallette needs to be removed, lift the whole machine from the bottom and set it aside.

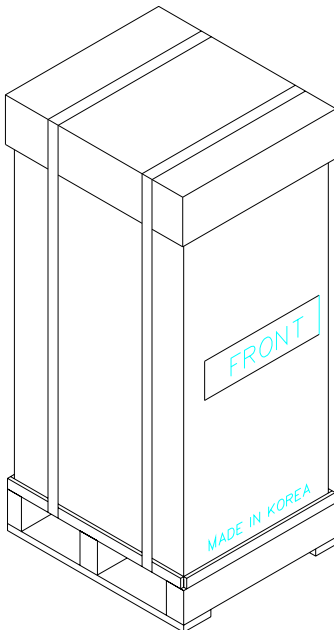

Fig. 4.1.1

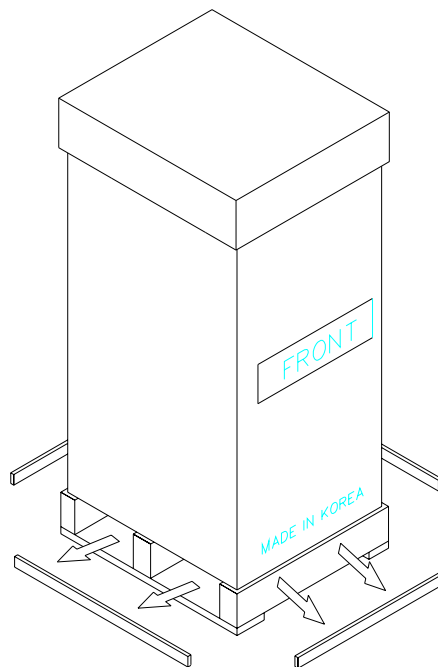

Fig. 4.1.2

4.2 Physical Installation

To install the Mini-Bank 1500 series ATM, perform the following steps.

- 1) Place the “Anchor bolts locate sheet” at the place where the machine is to be installed. (refer to Fig. 4.2.1)
- 2) Place the system on a flat surface, the system has a tendency to tip over if the surface is over 10 degrees. (refer to Fig 4.2.2) Be careful when opening the top or bottom of the machine s it will be off balance
- 3) Place the Anchor nuts into the ground according to the anchor bolts locate sheet. (4 places)
- 4) Place the Mini-Bank 1500 on top of the sheet.
- 5) Open the Security cover with the key provided.
- 6) Using the supplied combination (factory preset at 50-25-50) open the Security Door. This combination should be changed as soon as possible. Refer to Appendix B for instructions on changing the lock combination.
- 7) After the anchor nuts are in place according to the anchor holes on the bottom of the Mini Bank 1500, tighten the anchor bolts tightly. (refer to Fig. 4.2.3)

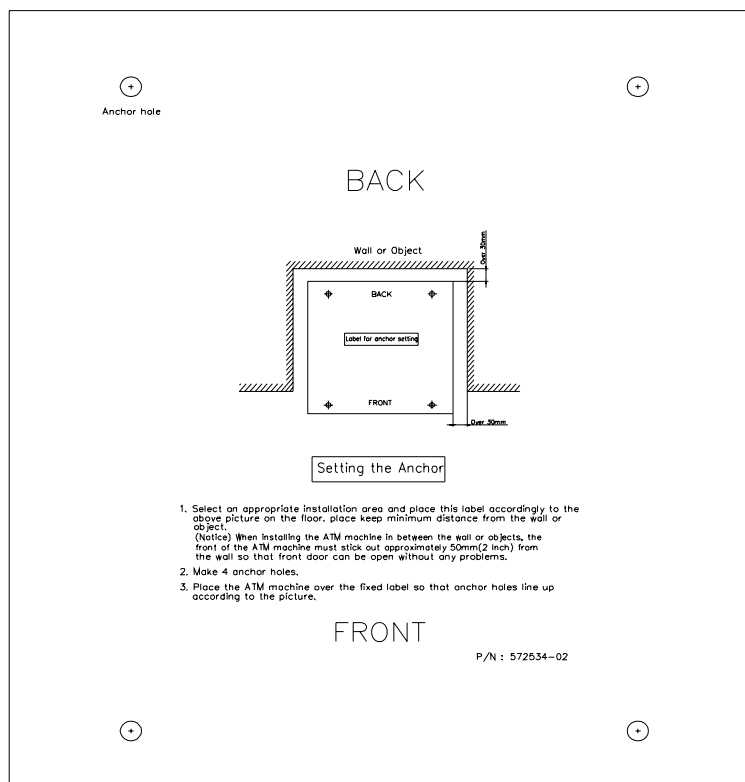

Fig. 4.2.1

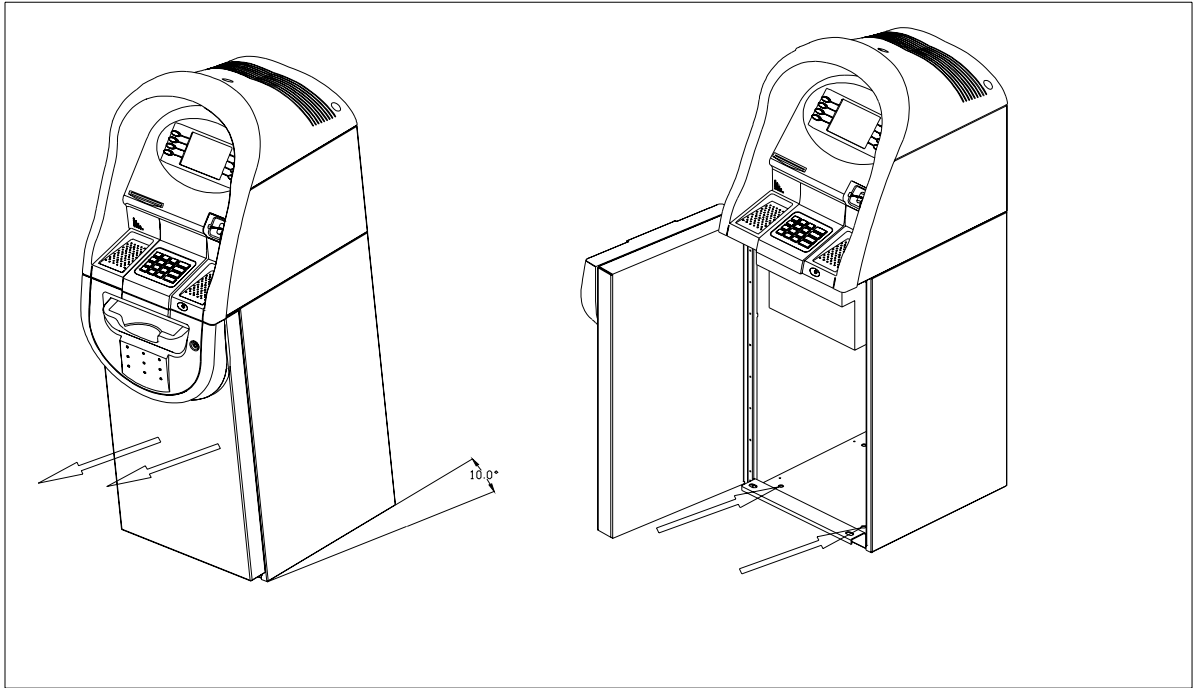

Fig. 4.2.2

Fig. 4.2.3

4.3 Hardware Installation

- 1) Verify the power voltage (110/220V) to be used and set the appropriate voltage on the power supply.
- 2) Verify that the telephone line to be used for the ATM is in proper working order. Hyosung recommends the use of shielded phone line in locations with close proximity to other appliances.
- 3) Open the security door and remove any shipping materials and note any warning or installation instructions.
- 4) Remove the screw, which is set to hold the Cash Dispensing Unit platform in place.
- 5) Remove the cash cassette from the box, fill the cassette with the appropriate amount of notes, and place it in the Cash Dispensing Unit carefully. Place the appropriate denomination label on the front of the cassette.
- 6) Before closing the vault, thoroughly test the combination lock by locking and unlocking the lock several times. It is much easier to diagnose potential lock problems before shutting the door
- 7) Open the top of the ATM. Place the receipt paper in the Receipt Printer. The paper prints only on one side (shiny side) always check the roll when you install paper. Place the roll so that the coated side (shiny side) will be facing up.
- 8) Connect the Power cable and telephone cable to the appropriate outlets on the wall. (verify once again if the power voltage is 110V or 220V)
- 9) Turn the power on and verify if all systems are operational. If any part of the system is not operational then an error code will be displayed. Verify with the Error Code and follow the appropriate steps. If the error is not corrected please contact your local distributor. Set all the system parameters. For more detailed information refer to Section 6 and Section 7.